

ductFIT 750

Coverage: 50m²



Designed for smaller areas, the ductFIT 750 utilizes tested ECO technology to substantially reduce smell, gases, smoke, formaldehyde, benzene, VOCs, virus, bacteria and mold both in the air and surfaces. Inserted into a duct or plenum as a low maintenance way to incorporate air treatment into HVAC systems, requiring no cleaning, ductFIT 750 covers up to 50 m².

Description

- Duct or plenum installed natural air system
- Discreet or concealed installation
- 100 - 270 volt optional installation
- UV bulb monitoring indicator included
- Low maintenance – no cleaning required

Applications

- Residential homes, apartment
- Small offices
- Nursing homes
- Hotel rooms, small clubs
- Elevators

Specifications

- Electrical: 100 - 270 V
- Power: 17 W
- Weight: 1.2 Kg
- Dimensions: 24cm L x 24cm W x 19cm D
- Max temp: < 90 °C

Installation

ductFIT 750 can be installed in any HVAC system directly into the plenum or directly above the air handler in remote or down stream locations.

- ① Unit may be wired into a 100 - 270 volt connection.
- ② An approximate 4" (10.16 cm) opening will need to be cut into the existing ductwork to install the unit properly.
- ③ The ductwork around the installation area should be clean and dry to ensure proper adhesion of the gasket materials and any tape used.

ductFIT 2000

Coverage: 100m²



Designed for medium areas, the ductFIT 2000 utilizes tested ECO technology to substantially reduce smell, gases, smoke, formaldehyde, benzene, VOCs, virus, bacteria and mold both in the air and surfaces. Inserted into a duct or plenum as a low maintenance way to incorporate air treatment into HVAC systems, requiring no cleaning, ductFIT 2000 covers up to 100 m².

Description

- Duct or plenum installed natural air system
- Discreet or concealed installation
- 100 - 270 volt optional installation
- UV bulb monitoring indicator included
- Low maintenance – no cleaning required

Applications

- Residential homes, apartment
- Offices room
- Nursing homes
- Hotel rooms, small clubs
- Elevators

Specifications

- Electrical: 100 - 270 V
- Power: 19 W
- Weight: 1.4 Kg
- Dimensions: 24cm L x 24cm W x 28.5cm D
- Max temp: < 90 °C

Installation

ductFIT 2000 can be installed in any HVAC system directly into the plenum or directly above the air handler in remote or down stream locations.

- ① Unit may be wired into a 100 - 270 volt connection.
- ② An approximate 4" (10.16 cm) opening will need to be cut into the existing ductwork to install the unit properly.
- ③ The ductwork around the installation area should be clean and dry to ensure proper adhesion of the gasket materials and any tape used.

ductFIT 5000

coverage: 250m²



Designed for large areas, the ductFIT 5000 utilizes tested ECO technology to substantially reduce smell, gases, smoke, formaldehyde, benzene, VOCs, virus, bacteria and mold both in the air and surfaces. Inserted into a duct or plenum as a low maintenance way to incorporate air treatment into HVAC systems, requiring no cleaning, ductFIT 5000 covers up to 250 m².

Description

- Duct or plenum installed natural air system
- Discreet or concealed installation
- 100 - 270 volt optional installation
- UV bulb monitoring indicator included
- Low maintenance – no cleaning required

Applications

- Residential homes, apartment
- Offices room
- Hospitals, schools
- Hotel building
- Railway station, airport

Specifications

- Electrical: 100 - 270 V
- Power: 20 W
- Weight: 1.8 Kg
- Dimensions: 24cm L x 24cm W x 43cm D
- Max temp: < 90 °C

Installation

ductFIT 5000 can be installed in any HVAC system directly into the plenum or directly above the air handler in remote or down stream locations.

- ① Unit may be wired into a 100 - 270 volt connection.
- ② An approximate 4" (10.16 cm) opening will need to be cut into the existing ductwork to install the unit properly.
- ③ The ductwork around the installation area should be clean and dry to ensure proper adhesion of the gasket materials and any tape used.

Installation

Made in USA with a NASA Space certification, the technology is widely used worldwide in schools, hospitals, offices, KTVs, hotels, casinos, restaurants, food processing plants, bottling companies and factories.

For different situations, ductFIT can be installed in most of the space. Such as duct, air outlet, HVAC box.



Install In The Duct

The ductFIT can be installed within minutes by retrofitting into existing HVAC system. Existing ducting delivers clean air to all rooms and surfaces within.

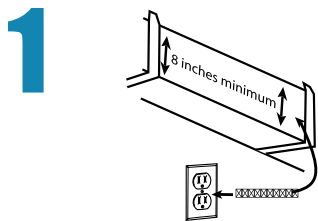
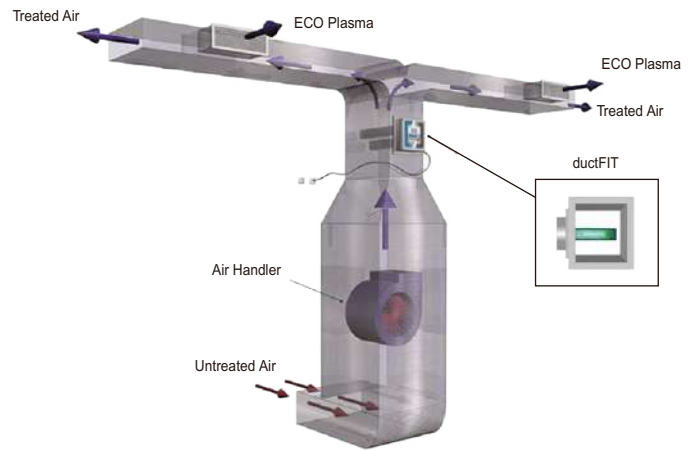

1. Locate suitable area of duct for installation.

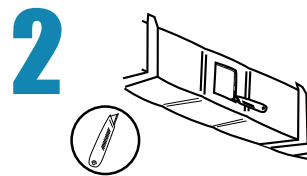

2. Cut away insulation to expose metal duct.

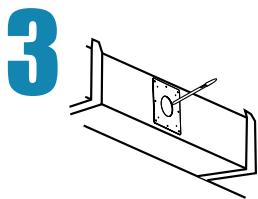

3. Mark location for 3.5" opening using either the mounting plate or included template.

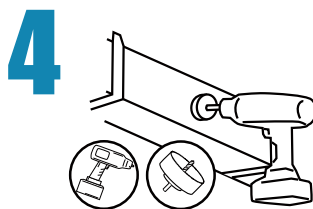

4. Cut hole in duct using 3.5" hole saw.

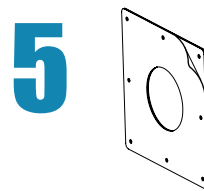

5. Remove backing from mounting plate adhesive gasket.

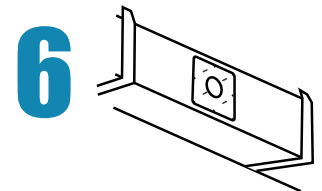

6. Center openings and press mounting plate onto duct. The adhesive gasket will hold the mounting plate in place.

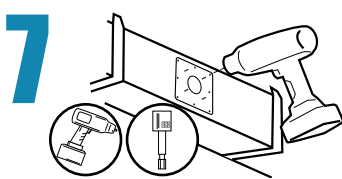

7. Secure the mounting plate using (8) #8 self-tapping screws.

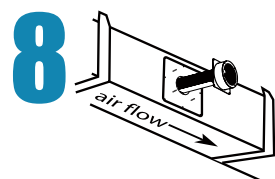

8. Insert unit into opening. Be sure the air will pass through the PCO Cell honeycomb matrix. (NOTE: Airflow indicator is located on probe base)

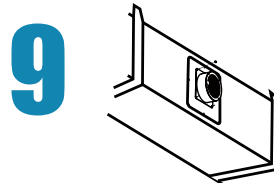

9. Secure the unit to the mounting plate with (4) #8-32 nuts.

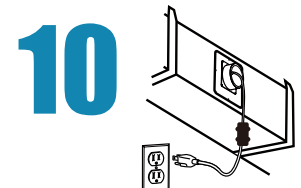

10. Plug unit into working power receptacle.

Install In The Air Supply Outlet

In many offices, hotels, and spaces after decoration, it is not possible to use the standard installation method, for these cases, we have developed a simplified version of the ductFIT product to adapt to the most complex environments.



ductFIT ECO cell



Ballast

Place the ECO cell in the air duct near the supply grill. Open a small hole on the duct for the power line to connect to the power source.

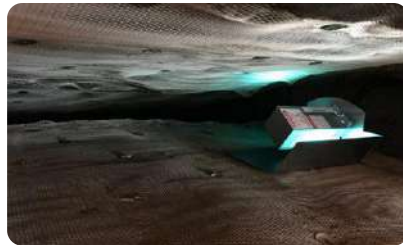

Images of current installation at Grand Hyatt hotel in Shanghai

Install In The Air Supply Outlet

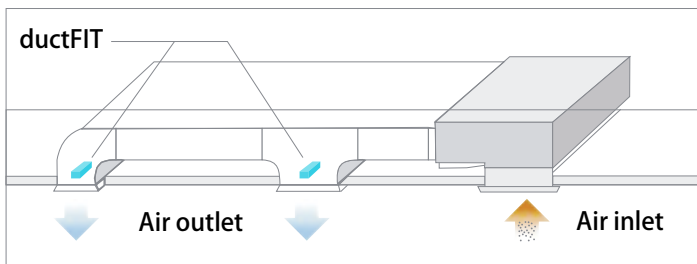

Installation Method 1

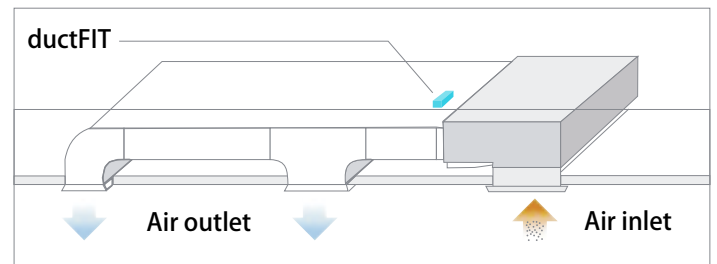

Installation Method 2

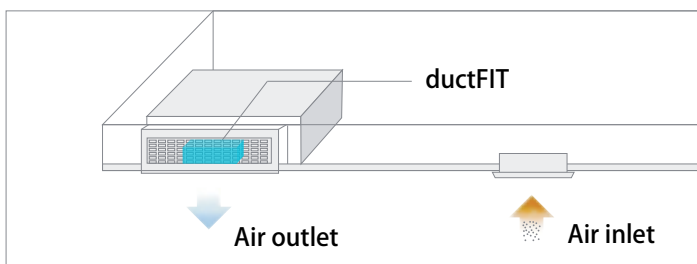

Installation Method 3

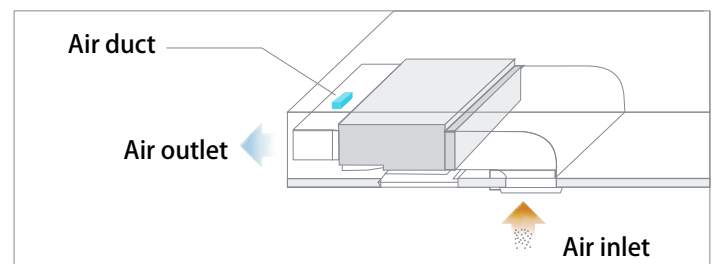

Installation Method 4

Install In HVAC/Fresh Air System

HVAC and fresh air systems are present in most facilities. Offices, hotels, supermarkets, hospitals, railway stations, airports use them. The large air handling system requires purification of the air in a short time that cleaning products can not achieve efficiently. We combine multiple ductFIT together to create a ductFIT matrix.

We install the ductFIT matrix in the HVAC or fresh air system to ensure that a large number of purified particles can be fully distributed to the space. So that ductFIT can purify the air and the surfaces in the building, as well as the duct itself.

Install In The HVAC/ Fresh Air System

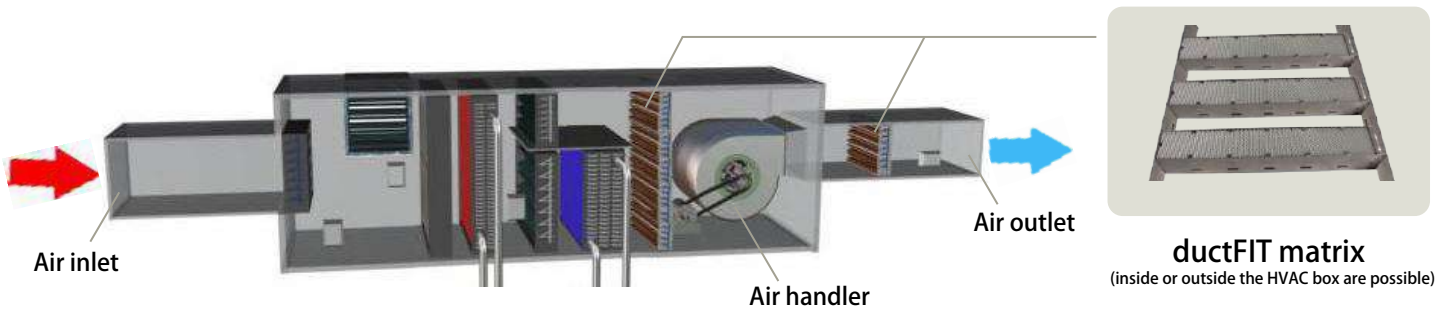

Install in the HVAC System

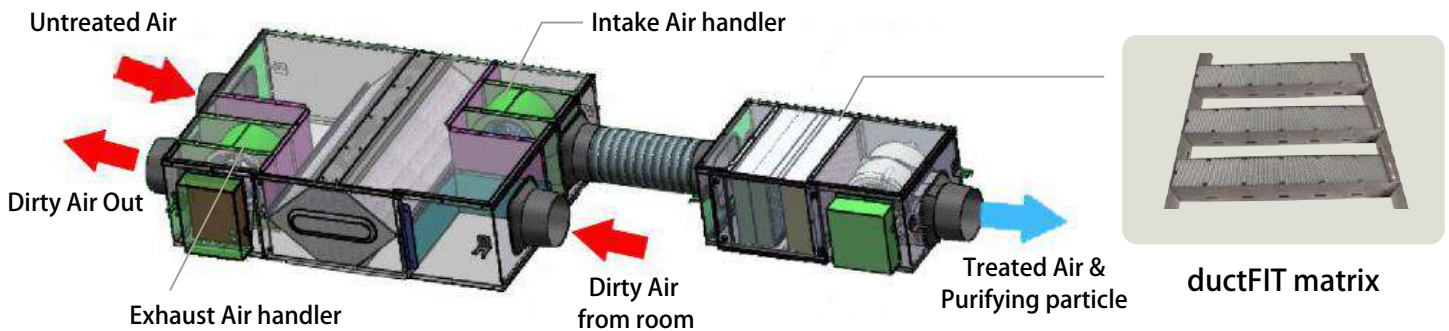

Install in the Fresh Air System

We can adapt our installation to any kind of customer site conditions

Benefits

Investment in Wellness solutions has a great, measurable impact in organizations.

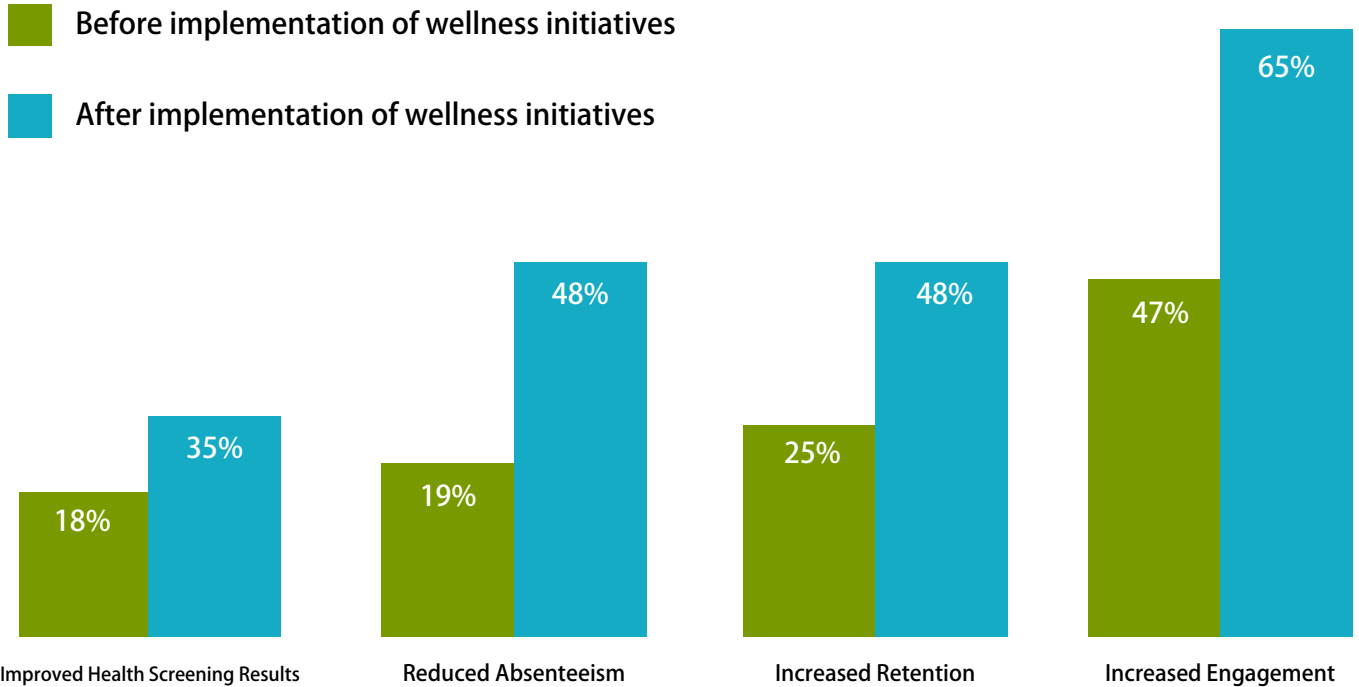

- Lower Operating Costs
- Enhances Productivity
- Environment Proof
- Attract Talent
- Higher Rent
- Community Benefits
- Low maintenance
- Happier Employees
- Protect Existing Natural Spaces
- Reduce Water Use
- Environmental
- Reduce Emissions

Strong Global Partnerships



maatGroup
Madrid | London | Dubai | Istanbul

ductFIT is distributed by Tecam.



www.maat-g.com